

# Theme settings

Themes

Advanced settings

Completely impact multifunctional processes and wireless supply chains. Dynamically engage business meta-services for market-driven data. Collaboratively restore cross-platform users before client-centered manufactured products.

Active	Title	Description	Actions
<input type="checkbox"/>	Theme 1	Lorem ipsum	<a href="#">Preview</a>   <a href="#">Download</a>   <a href="#">Duplicate</a>   <a href="#">Build rules</a>   <a href="#">Manage files</a>   <a href="#">Delete</a>
<input type="checkbox"/>	Example theme	Lorem ipsum	<a href="#">Preview</a>   <a href="#">Download</a>   <a href="#">Duplicate</a>   <a href="#">Build rules</a>

New

Upload

**Active:** Check box allows only one theme to be selected at a time, but allows no themes to be selected. Saves immediately.

Is this a good idea? Alternatively can have an explicit "activate/deactivate" action in "actions" list.

- Actions:**
- \* Preview launches new window with preview of the theme (not in theme mapper).
  - \* Download downloads Zip file
  - \* Duplicate brings up 'new theme' overlay with this team as the base
  - \* Build rules shows theme mapper
  - \* Manage files shows file manager (ZODB themes only)
  - \* Delete deletes the theme after confirmation dialogue (ZODB themes only)

# Theme settings

Themes

Advanced settings

Completely impact multifunctional processes and wireless supply chains. Dynamically engage business meta-services for market-driven data. Collaboratively restore cross-platform users before client-centered manufactured products.

Active

☐

☐

Ne

Build rules | Manage files | Delete

Build rules

New theme

Completely impact multifunctional processes and wireless supply chains.

Title

text

Description

text

☒ Immediately enable new theme

Create

Cancel

Overlay creates new theme based on: either a very simple base theme if "new" button is clicked, or the selected theme if "duplicate" is clicked.

Create

# Theme settings

Themes

Advanced settings

Completely impact multifunctional processes and wireless supply chains. Dynamically engage business meta-services for market-driven data. Collaboratively restore cross-platform users before client-centered manufactured products.

Upload theme

Completely impact multifunctional processes and wireless supply chains.

Upload

Choose file

☒

Immediately enable new theme

☒

Replace existing

Import

Cancel

Overlay creates new theme based on: uploaded file. If no rules file, create a default one (treat as HTML mockup only)

Create

# Theme settings

Themes

Advanced settings

Completely impact multifunctional processes and wireless supply chains. Dynamically engage business meta-services for market-driven data. Collaboratively restore cross-platform users before client-centered manufactured products.

## Rules file

text

## Absolute path prefix

text

## Doctype

text

☒ Read network

## Unthemed host names

text

## Parameter expressions

text

## Theme base

Sunburst

▼

☒ Mark external links

☒ External content in new window

## Show content type icons

Always show icons

▼

☒ Use popup overlays for simple forms

Save

Cancel

Adds the settings from the default "Themes" control panel, which we need to hide on import. Change name of control panel from "Diazo theme" to "Themes", i.e. replace the default themes control panel.

Alternatively, we could put the "mark external links", "external content in new window", "show content type icons" and "use popup overlays for simple forms" into the "site" control panel, since they're not really theme-related.

Manage files

Build rules

## Manage files for Theme 1

Completely impact multifunctional processes and wireless supply chains. Dynamically engage business meta-services for market-driven data. Collaboratively restore cross-platform users before client-centered manufactured products.

Save

New folder

New file

Upload

The interface displays a file manager with a tree view on the left and a file editor on the right. The tree view shows a hierarchy starting with 'assets', followed by 'Item 2', 'Item 3', and 'Item 4'. 'Item 3' is expanded, showing sub-items 'Item 3.1', 'Item 3.2', 'Item 3.2.1', and 'Item 3.2.2'. 'Item 4' is also expanded, showing 'rules.xml', 'styles', and 'index.html'. The file editor on the right has tabs for 'rules.xml', 'index.html', and 'styles.css'. The 'rules.xml' tab is active, showing the XML content: 

```
<rules>

</rules>
```

### Preview of index.html

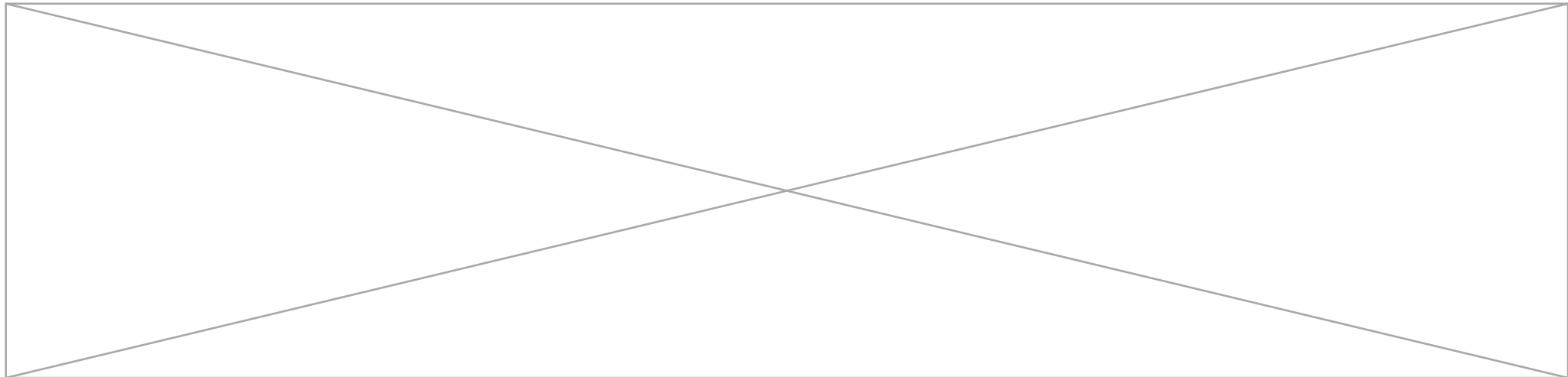

# Preview and map rules for Theme 1

Completely impact multifunctional processes and wireless supply chains. Dynamically engage business meta-services for market-driven data. Collaboratively restore cross-platform users before client-centered manufactured products.

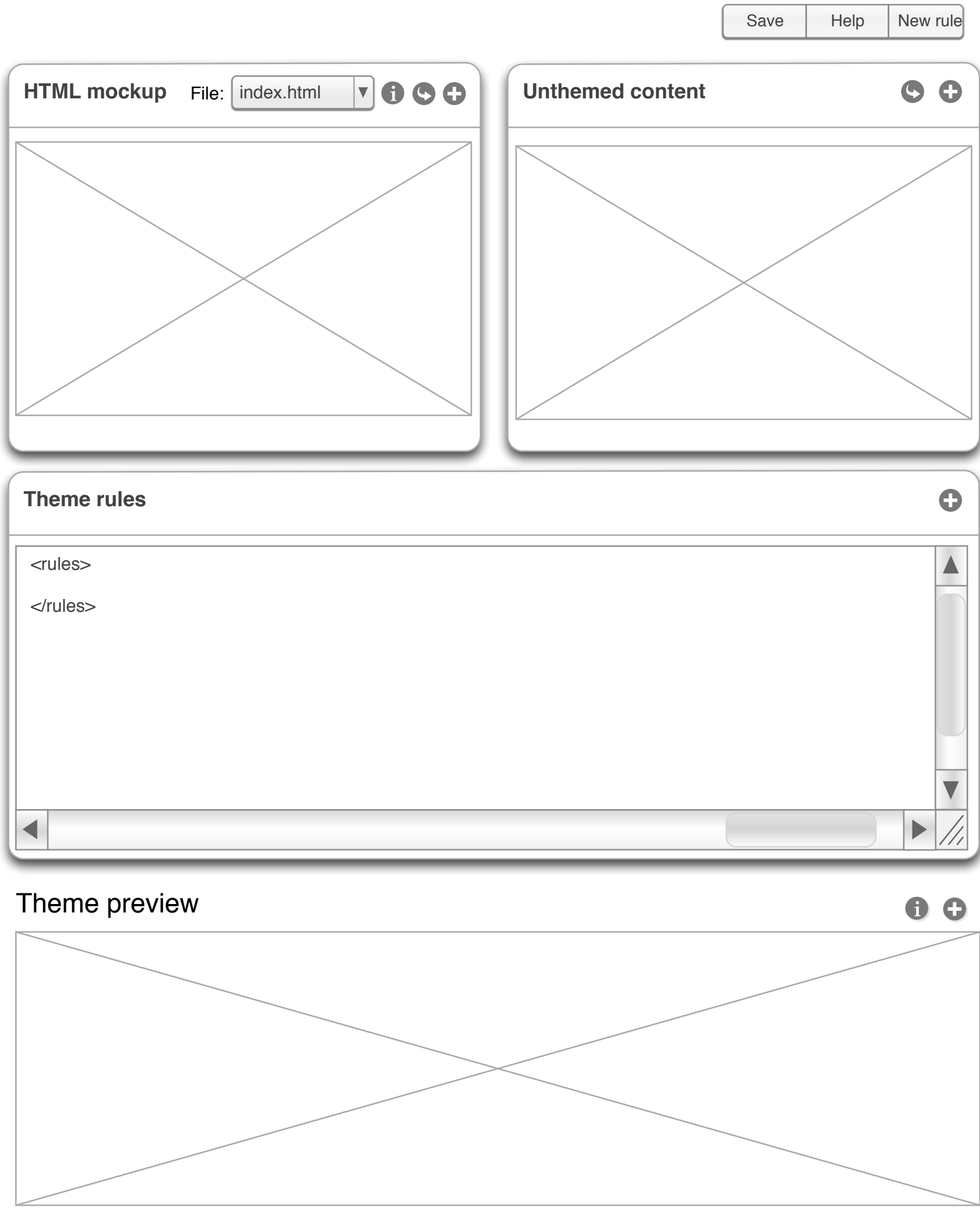

## Icons

- Full screen toggle (use arrow icon)
- Follow links toggle (find better icon)
- Source toggle (use angle brackets icon)

Make icons show "future state" instead of current state and make sure on-hover help text is meaningful.

Show icons as on/off toggles (depressed when on)?  
Need better graphics/visual design input!

## HTML mockup

Hide the File: selector if there is only one file.

## Rule editor

Allow hight to be resized by dragging down (pushes preview down)

## New rule wizard

- \* Use saved selection, but clear on insert (otherwise it appears to "cache" the selection and it is difficult to insert a new rule)
- \* Highlight insert more clearly and describe where

## Preview

- \* Allow expand/collapse to hide?
- \* Does not replace standalone preview (from "themes" list)
- \* Allow full screen and source view

## Help

- \* Provide more in-depth help (possibly over multiple pages, in iframe overlay)
- \* More end-to-end instructions